

# SIXTH DISTRICT

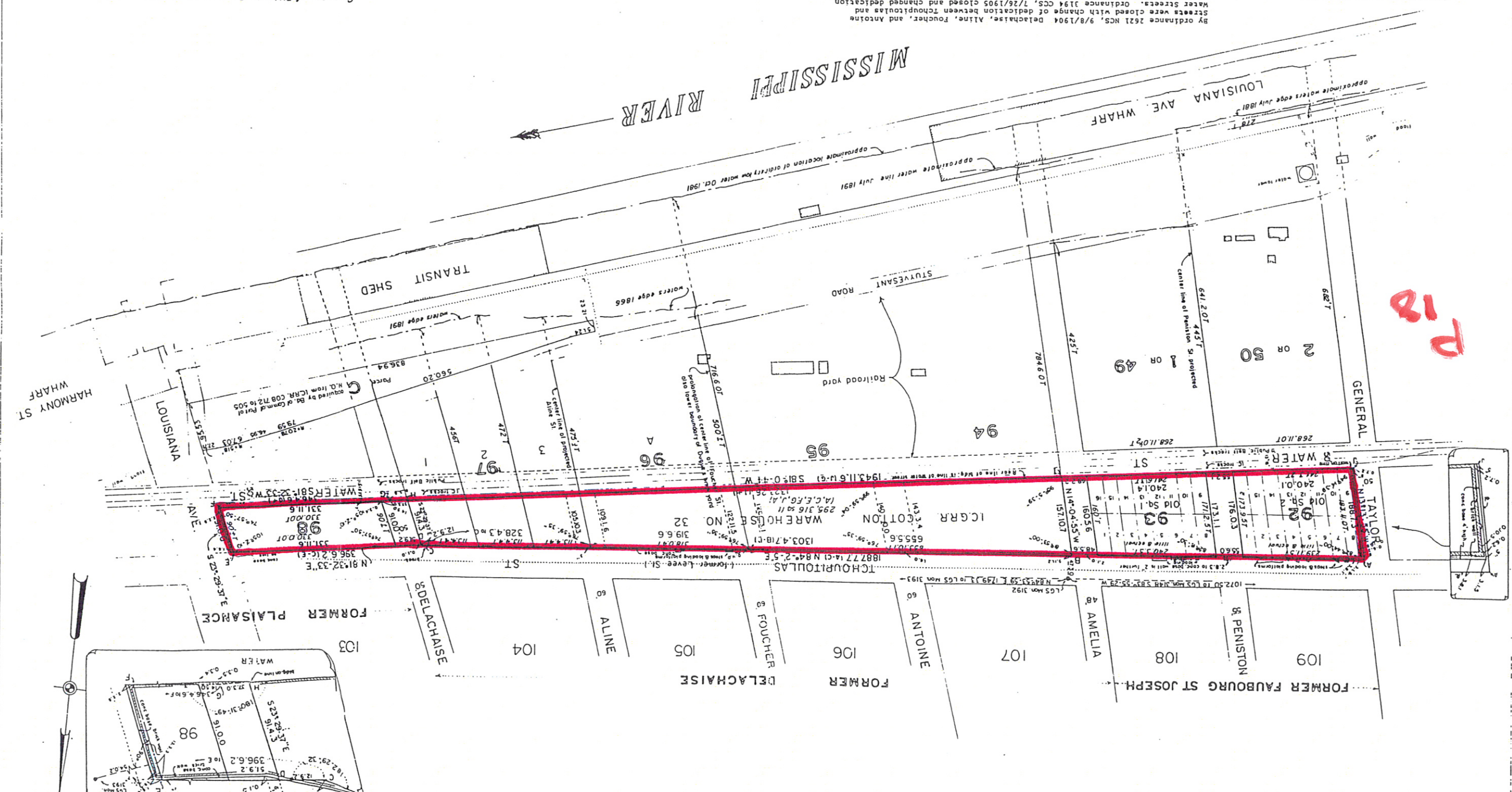

STREETS PROPOSED TO BE LEASED

PENISTON ST.	9600.8 sq. ft.
AMELIA ST.	7841.8 sq. ft.
ANTOINE ST.	8498.9 sq. ft.
FOUCHER ST.	7478.9 sq. ft.
DELACHAISE ST.	6450.3 sq. ft.
See Ordinance No.	4556.2 sq. ft.

240.3 ST denotes title dimension in feet, inches, & eighths.

SCALE 1" = 100'

These utility poles within property line along Tchoupitoulas St. side of Cotton Warehouse No. 32.

Bearings refer to Lo. Plane Lambert Grid derived from monuments B-3188, B-3192 & B-3193.

By ordinance 2621 NCS, 9/8/1904 Delachaise, Aline, Foucher, and Antoine Streets were closed with change of dedication between Tchoupitoulas and Water Streets. Ordinance 1194 CCS, 7/26/1905 closed and changed dedication of Peniston and Amelia Streets between Tchoupitoulas and Water Streets. Both ordinances extend for balance of term of Stuyvesant Dock grant ordinance 11765 CS, 1/14/1896 which expires 1/14/1995.

We have seen no descriptions, nor plan of subdivision which would furnish geometry, dimensions, etc. for those four unnumbered squares between Amelia, Delachaise, and Water Streets, the existence of which is inferred by the above ordinances. In order to create such geometry for these four unnumbered squares as well as the location of Water Street between Taylor Street and Louisiana Ave. we have adopted the location of the as built wall of the warehouse for the location of Water Street. The location of Peniston, Amelia, Antoine, Foucher, Aline, and Delachaise Streets are based on a projection of their as built locations on the north side of Tchoupitoulas Street.

*Coffman Kuhn*

Survey of Illinois Central Gulf Railroad Co.  
Cotton Warehouse No. 32  
New Orleans, La., Nov. 24, 1981.  
Certified correct by Lawyers Title Insurance Corp.; John H. Bertel, C. Alvin Bertel, Jr. and Illinois Central Gulf Railroad Co.

