

Attachment C - Parcel to be added (red-lined) 1724 Texas and 1731 Myrtle (0.76 acres)

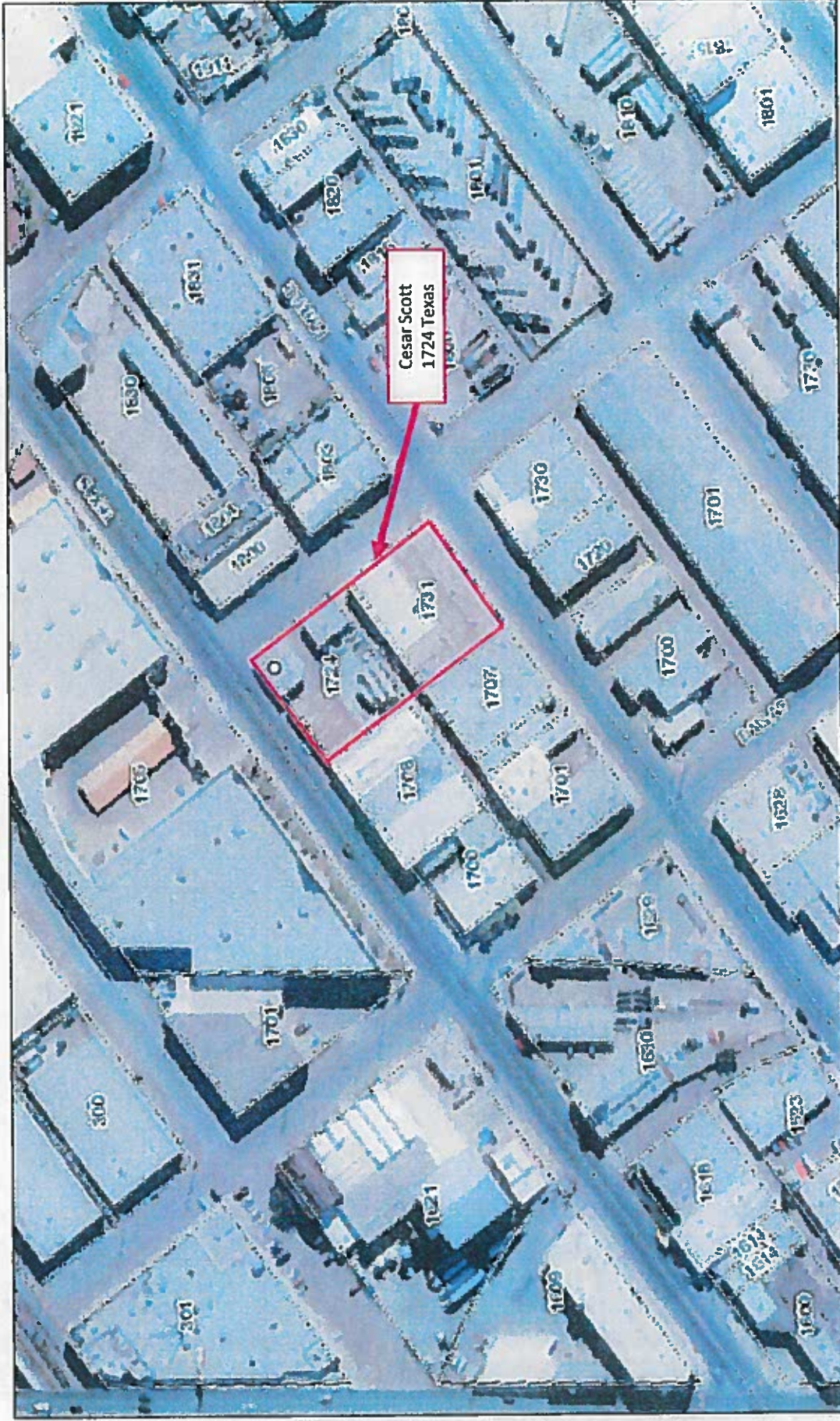

January 10, 2019

- Override 1 Foreign Trade Zone
- Major Roads
- FTZ General Purpose
- International Bridges
- Subzone

1:2,257



CAO, TX Orthoregistry Program, USDA FSA, DigitalGlobe, GeoEye

Me
Copyright 2014