

OWNERSHIP MAP

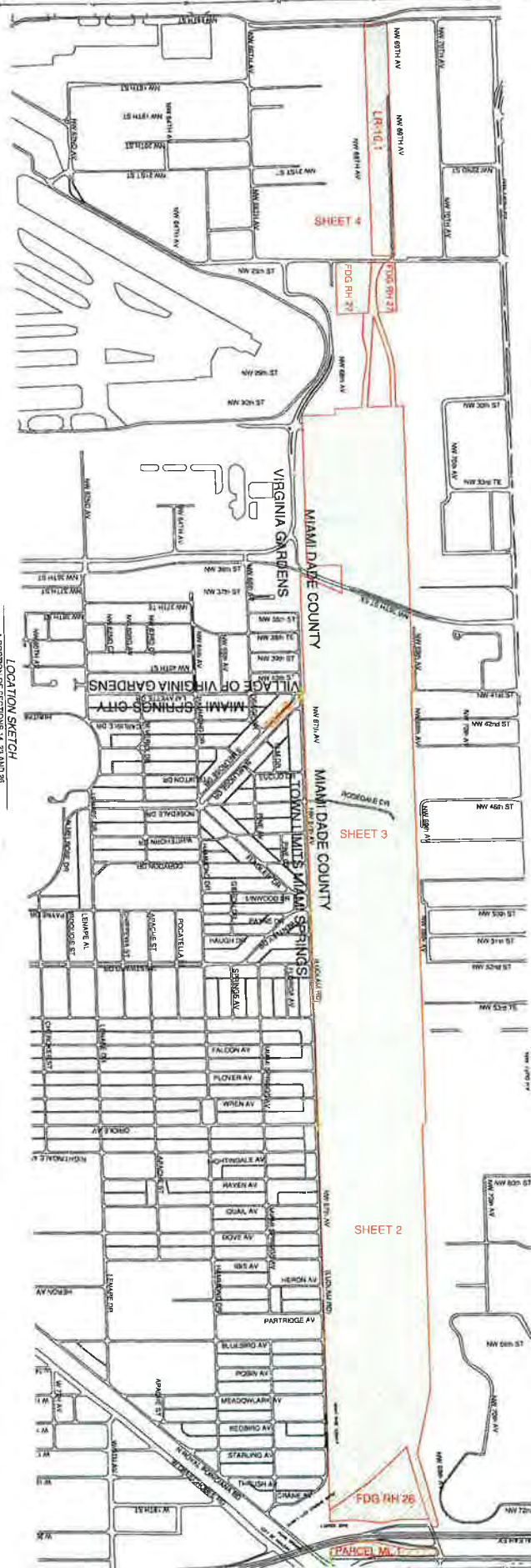

LOCATION SKETCH
 A PORTION OF SECTIONS 14, 23 AND 28
 TOWNSHIP 53 SOUTH, RANGE 40 EAST
 MIAMI-DADE COUNTY, FLORIDA
 SCALE: 1" = 75'

OWNERSHIP MAP HIALEAH YARD	MIAMI-DADE COUNTY, FLORIDA	 LUDOVICI & ORANGE CONSULTING ENGINEERS, INC. <small>329 PALERMO AVENUE CORAL GABLES FLORIDA 33134 305-444-1000 - LB 1012</small>	NO. DATE REVISIONS BY
	SECS. 14, 23 AND 28 TOWNSHIP 53 SOUTH, RANGE 40 EAST		

