

HEACOCK STREET.

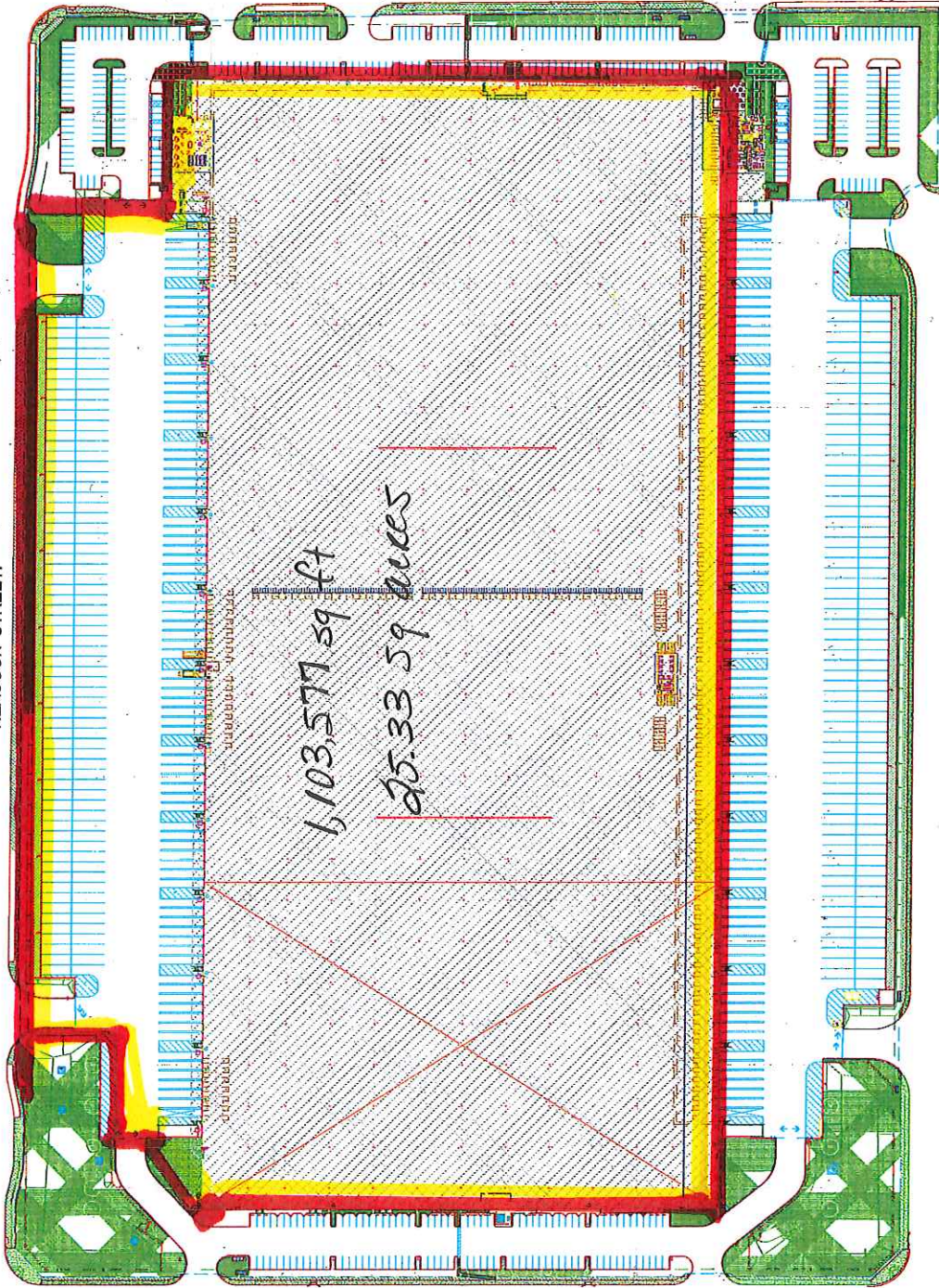

SHADED AREA DENOTES AREA TO BE ZONED, INCLUDING THE SIDE OF THE BUILDING FACING HEACOCK STREET. BUILDING SQFT IS 1,103,577. PARKING SQFT ALONG HEACOCK STREET IS 301,742

**Zoned**

IRIS AVENUE

KRAMERIA AVENUE

COSMOS STREET.

<b>MILESTONES</b>		<b>REVISIONS</b>		<b>REVISIONS</b>		<b>DC</b>	
DATE	BY	DATE	BY	DATE	BY	DATE	BY
PROJECT NO. 992 DRAWING NO. DC LAYOUT PLAN PROJECT NAME MORENO VALLEY RIVERSIDE, CA REGION WEST COAST TYPE 30000000 MAX. DATE 06/2000 SPECIAL TYPE DRAWN BY CHECKED BY PLOT 1		FIRM NAME FLOOR & DECOR FIRM ADDRESS 11111 Valley Way, CA 92551 PROJECT ARCHITECT INFORMATION PROJECT NO.		FIRM CONTACT INFORMATION FIRM PHONE NO. FIRM FAX NO. FIRM E-MAIL		FIRM WEBSITE FIRM ADDRESS FIRM PHONE NO. FIRM FAX NO. FIRM E-MAIL	