

View: Dana Global Trade Center - Port Terminals

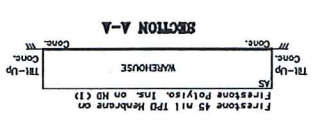

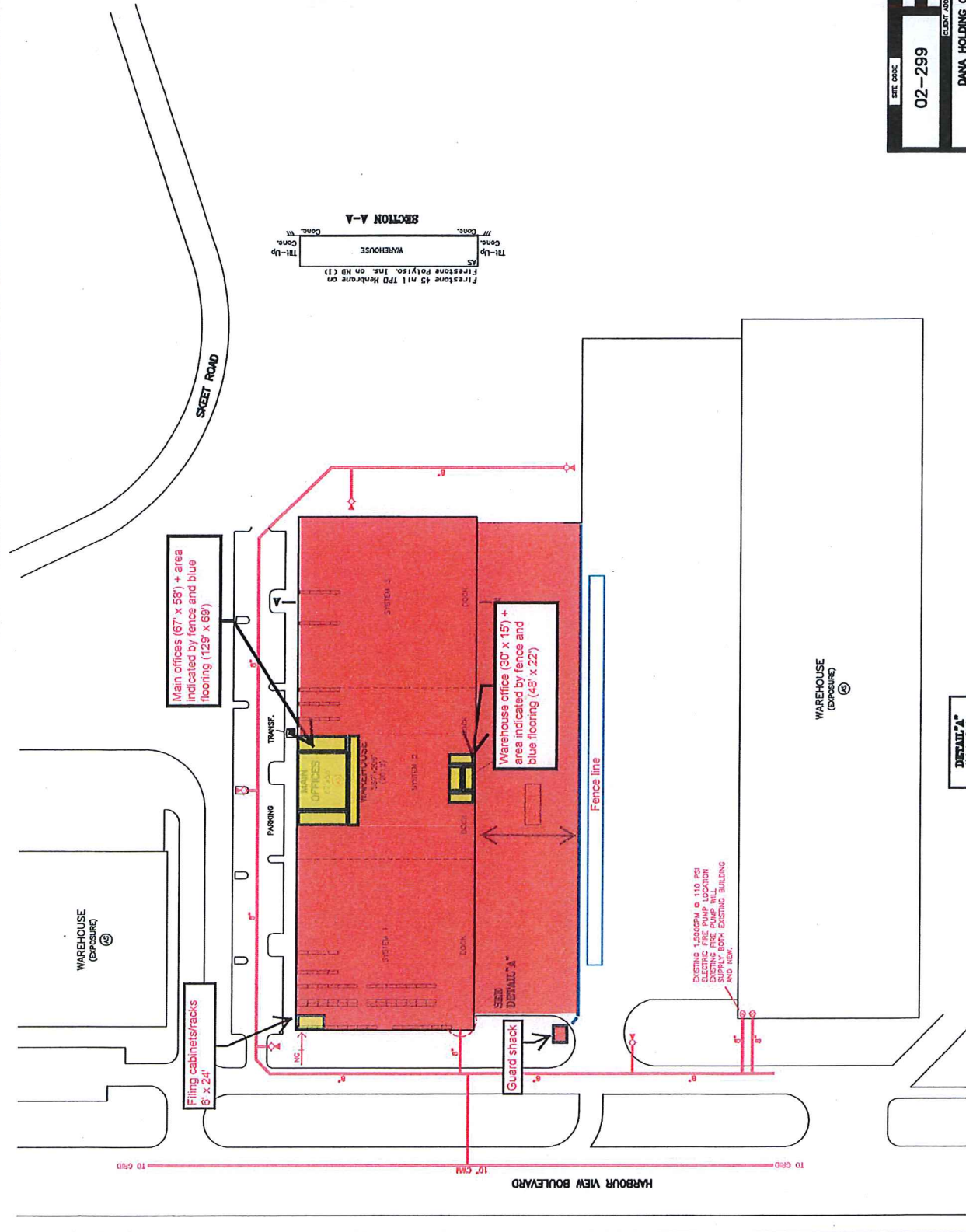

- COMPLETE CONNECTION
- NON-COMPLETABLE CONNECTION
- NON-SPRINKLED
- AUTOMATIC SPRINKLER
- MANUAL AUTOMATIC SPRINKLER
- AUTOMATIC FIRE ALARM
- POST INDICATION VALVE
- BATTERY VALVE
- DRY VALVE
- DRY VALVE IN PIT
- OTHER VALVE
- WALL VALVE
- CHECK VALVE
- DOUBLE CHECK VALVE
- FIRE DEPT. CONNECTION
- ALARM CHECK VALVE ON REEF
- OPEN AS REEF
- DRY PIPE VALVE
- DRY PIPE VALVE 1/4" I.D.
- SHOCK VALVE
- ELECTRIC NOTIFICATION ALARM
- REFRESH = FEED WATER DIS.
- RESERVE TEST VALVE
- HOSE CONNECTION
- DIESEL PUMP
- ELECTRIC PUMP
- LOGIC PUMP
- FIRE ALARM TEST VALVE
- MANUAL TEST VALVE
- TEST & SERVICE CONNECTION
- CITY HYDRANT
- HYDRANT, 2 PUMP CONNECTIONS
- HYDRANT, 1 BRIDGE
- HYDRANT, 1 CONNECTION
- WALL HYDRANT
- HOSE NOZZLE
- TRANSFORMER
- 3-TRANSF. (P.W. MOUNTING)
- ACCOUNTING GAS LINE
- VOLUME INTO
- TI100

SITE CODE: 02-299
 SCALE: 1"=80'
 CURRENT REVISION: 12/10/12
 DATE OF DESIGN: 12/10/12
 ENGINEER: K.P. Cullen
 CLIENT ADDRESS: DANA HOLDING CORPORATION
 GLOBAL TRADE CENTER
 8920 HARBOUR VIEW BLVD.
 SUFFOLK, VA 23435

MATRIX RISK CONSULTANTS
 CONSULTING ENGINEERS / ARCHITECTS
 11111 RIVER ROAD
 SUITE 200
 FALLS CHURCH, VA 22034
 TEL: 703.441.1111
 WWW.MATRIXRISK.COM



HYDRALICALLY DESIGNED SPRINKLER SYSTEMS

AREA PROTECTED	DENSITY	DESIGN	THROWING	NO. OF BRANCH	SPRINKLERS	HOSE	INCLUDED
SYSTEM 1	52 PS	12 HEADS	1,558.11	108.75	1,057	108.75	1,057
SYSTEM 2	52 PS	12 HEADS	1,558.11	108.25	1,057	108.25	1,057
SYSTEM 3	52 PS	12 HEADS	1,558.11	20.18	185F	20.18	185F

EXISTING LAYOUT IS NOT FOR ELECTRICAL FIRE PUMP LOCATION. EXISTING FIRE PUMP WILL BE WORK FOR EXISTING BUILDING AND NOT FOR THIS PROJECT.