

REVISIONS:
 △ 05/01/15 BUILDING DEP. COM.
 △ 01/04/16 COORDINATION
 △ 05/19/16 TP PERMIT COMMENTS

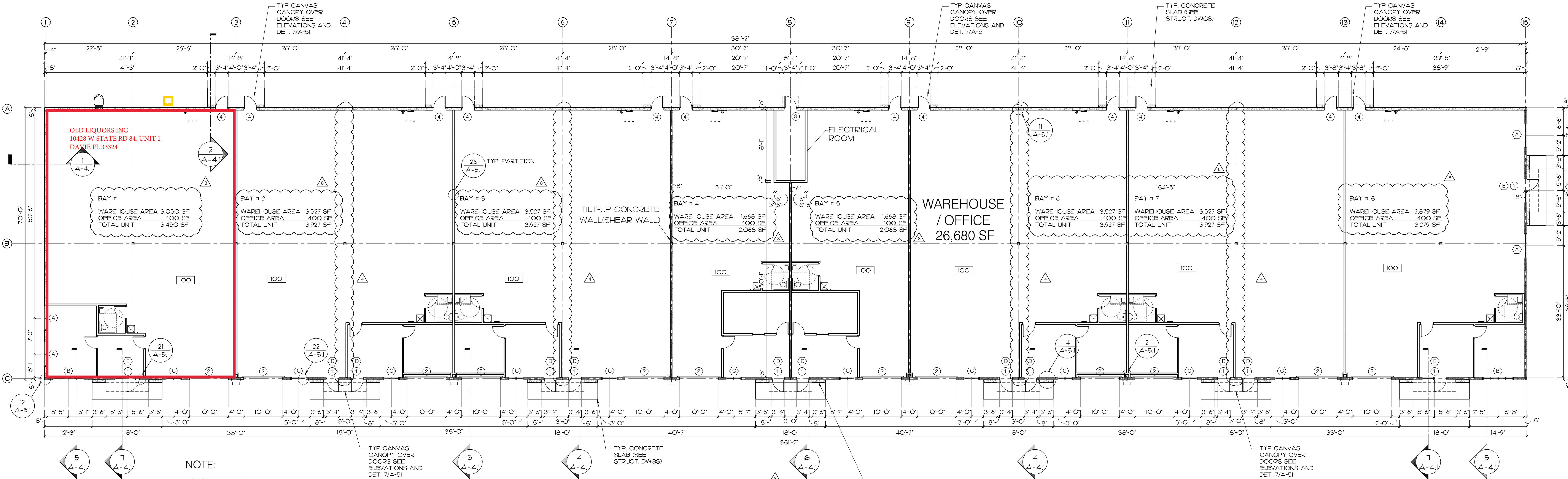

GROUND FLOOR
 SCALE 3/32" = 1'-0"

NOTE:
 FOR OVERLAPPING &
 JOINT PANELS SEE DETS
 I-H5 ON A-6

LEGEND

	6" PRECAST CONCRETE TILT WALL
	4'-6" FULL HEIGHT PARTITION WITH 1-HR. FIRE RATED TO UNDERSIDE OF ROOF DECK (TYP.) SEE DETAIL (237A-51)

MAXIMUM FLOOR AREA ALLOWANCE/OCCUPANT
 (TABLE 1004.12 (F.B.C.))

BUILDING GROUND FLOOR TOTAL OCCUPANT LOAD = 85 PERSONS.

OCCUPANT LOAD CALCULATION
 STORAGE (S-I) AND BUSINESS (B) OCCUPANCIES FROM (TABLE 1004.12 (F.B.C.))

THE OCCUPANT LOAD FACTOR IS:
 WAREHOUSE 5.00 SF/OCCUPANT
 OFFICE 100 SF/OCCUPANT

BAY # 1 AREA = WHS 3,050 SF AND OFFICE 400 SF	= 11 PERSONS
BAY # 2 AREA = WHS 3,527 SF AND OFFICE 400 SF	= 12 PERSONS
BAY # 3 AREA = WHS 3,527 SF AND OFFICE 400 SF	= 12 PERSONS
BAY # 4 AREA = WHS 1,668 SF AND OFFICE 400 SF	= 8 PERSONS
BAY # 5 AREA = WHS 1,668 SF AND OFFICE 400 SF	= 8 PERSONS
BAY # 6 AREA = WHS 3,527 SF AND OFFICE 400 SF	= 12 PERSONS
BAY # 7 AREA = WHS 3,527 SF AND OFFICE 400 SF	= 12 PERSONS
BAY # 8 AREA = WHS 2,879 SF AND OFFICE 400 SF	= 10 PERSONS
ELECTRICAL ROOM = 107 SQ. FT.	= 0 PERSONS
TOTAL AREA = 26,680 SQ. FT.	85 PERSONS

NFPA 1 CHAPTER 10 SECTION 10.13

FIRE PROTECTION MARKINGS:
 -NUMBERS SHALL HAVE PLACED IN A POSITION TO BE PLAINLY LEGIBLE AND VISIBLE FROM THE STREET OR ROAD FRONTING THE PROPERTY.
 -ADDRESS NUMBERS SHALL CONTRAST WITH THEIR BACKGROUND. NUMERALS SHALL BE NOT LESS THAN SIX INCHES IN HEIGHT AND SHALL BE ARABIC NUMERALS OR ALPHABET LETTERS.

APPLICABLE CODES

- CITY OF TOWN OF DAVIE ZONING CODE
- FLORIDA BUILDING CODE, 2014 5TH EDITION
- FLORIDA MECHANICAL CODE, 2014 5TH EDITION
- FLORIDA PLUMBING CODE, 2014 5TH EDITION
- NATIONAL ELECTRIC CODE, 2010 EDITION
- FLORIDA FIRE PREVENTION CODE, 2014 5TH EDITION

595 CORPORATE PARK OF COMMERCE-Bldg 12

DEVELOPER:
 595 Flex, LLC
 2645 N.E. 207th Street
 Aventura, FL 33180

PROJECT LOCATION:
 595 Corp Park of Commerce,
 Sate Road 84, Towne of Davie, Florida

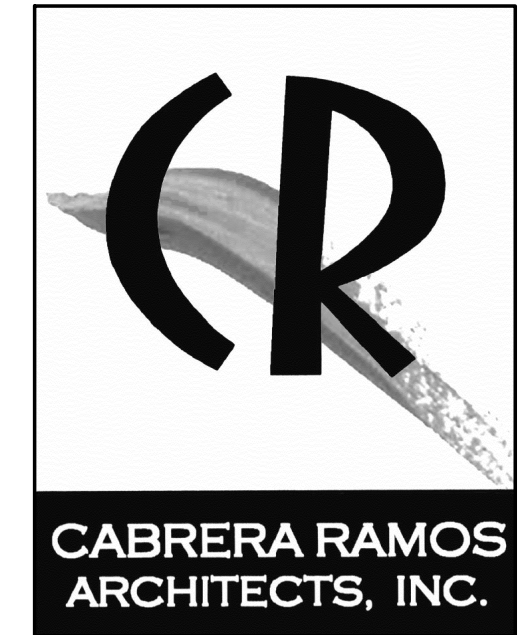

9851 N.W. 58th Street #107
 Doral, Florida 33178
 P. 305.593.0750 F. 305.593.8862
 AA 000621

MIGUEL A. CABRERA JR., R.A.
 State Reg. No. AR13118
 ROSA E. RAMOS-BOTTA, R.A.
 State Reg. No. AR15209

© 2015 CABRERA RAMOS ARCHITECTS, INC.
 The Design and Drawings for this Project are the property of the Architect and are protected under the Copyright Protection Act.

DATE: 04-10-2015
 DRAWN: RT
 CHECKED BY: RRB
 JOB NO.: 1930 - 14

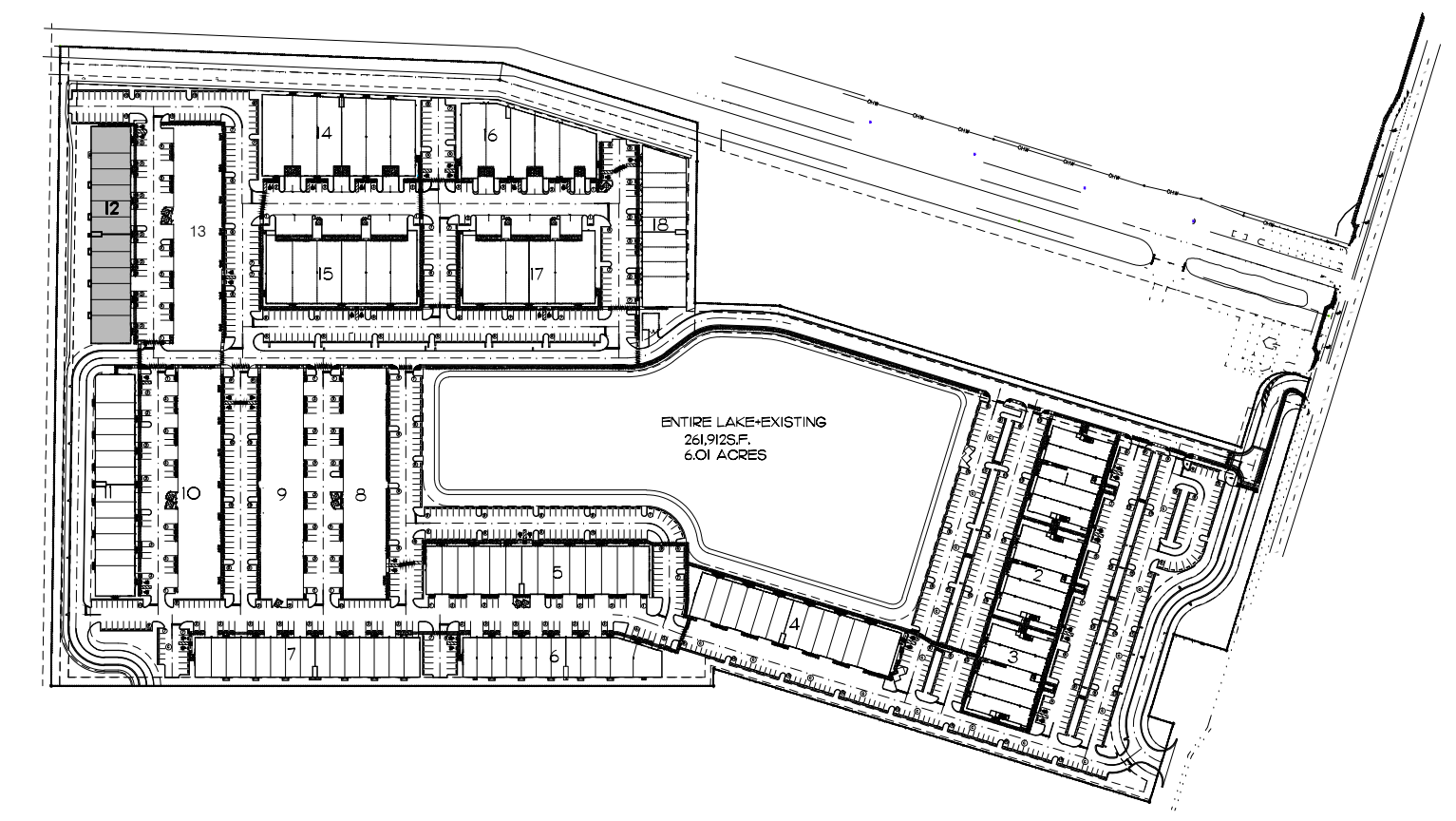

KEY PLAN
 SCALE: 1/8" = 1'-0"

SEAL

SHEET NO.
A-2.1
 of

Location Map

10428 W State Rd 84

Legend

 Old Liquors, Inc

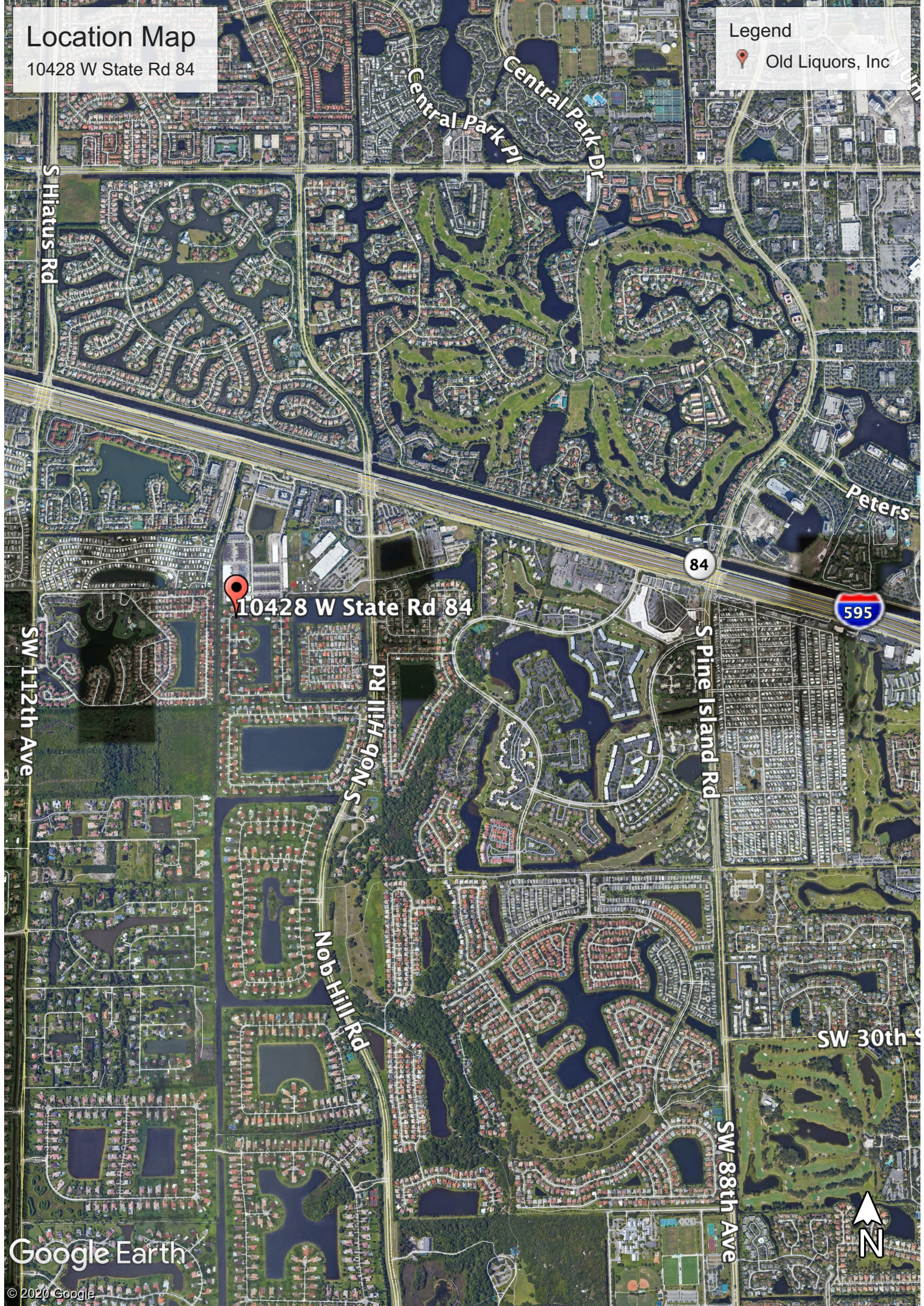

 10428 W State Rd 84