

HARLINGEN INDUSTRIAL PARK II & III

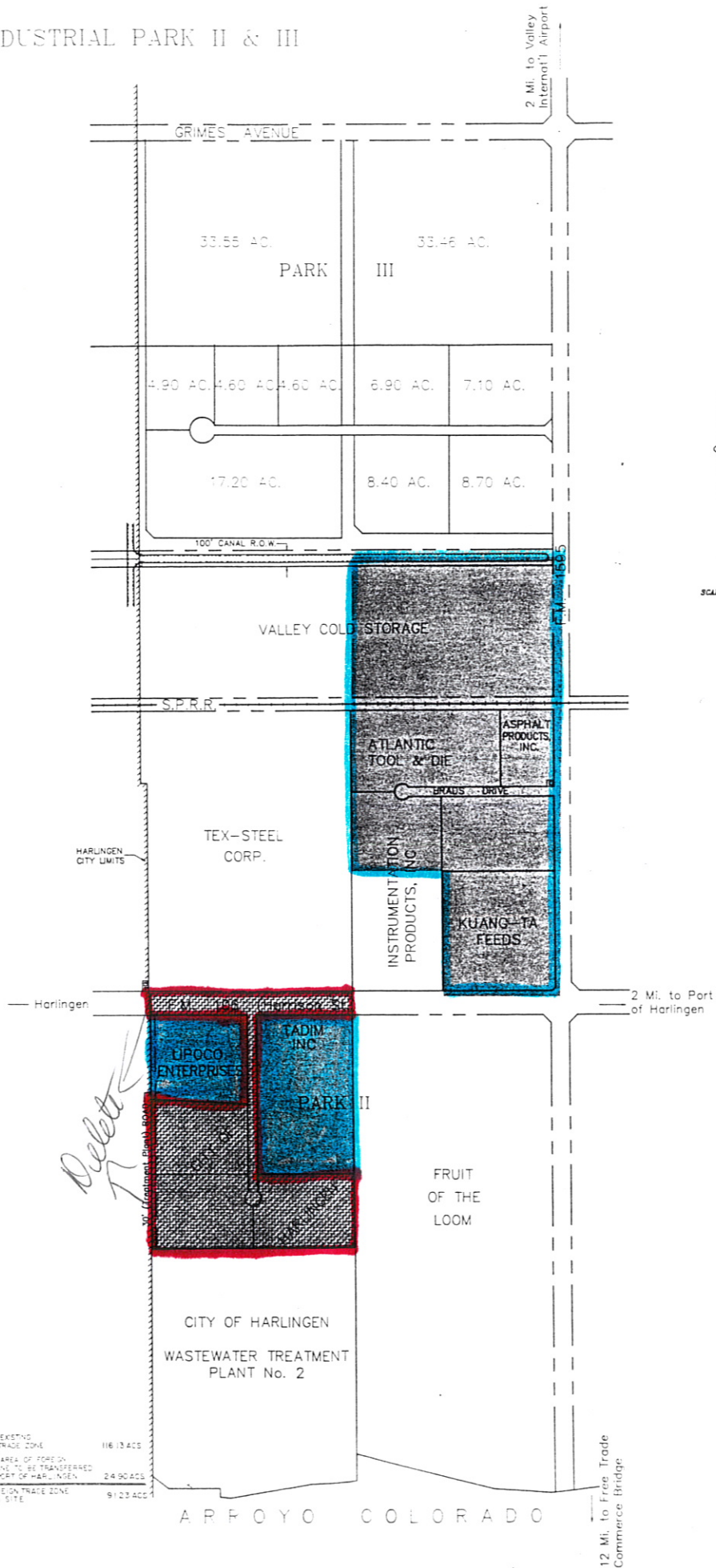

- DENOTES EXISTING FORE ON TRADE ZONE 116.13 AC.
- DENOTES AREA OF FORE ON TRADE ZONE TO BE TRANSFERRED TO THE PORT OF HARLINGEN 24.90 AC.
- REMAINING FORE ON TRADE ZONE AREA AT THIS SITE 91.23 AC.

Relet