

PROPOSED SITE 2 - AFTER BOUNDARY MODIFICATION APPROVAL

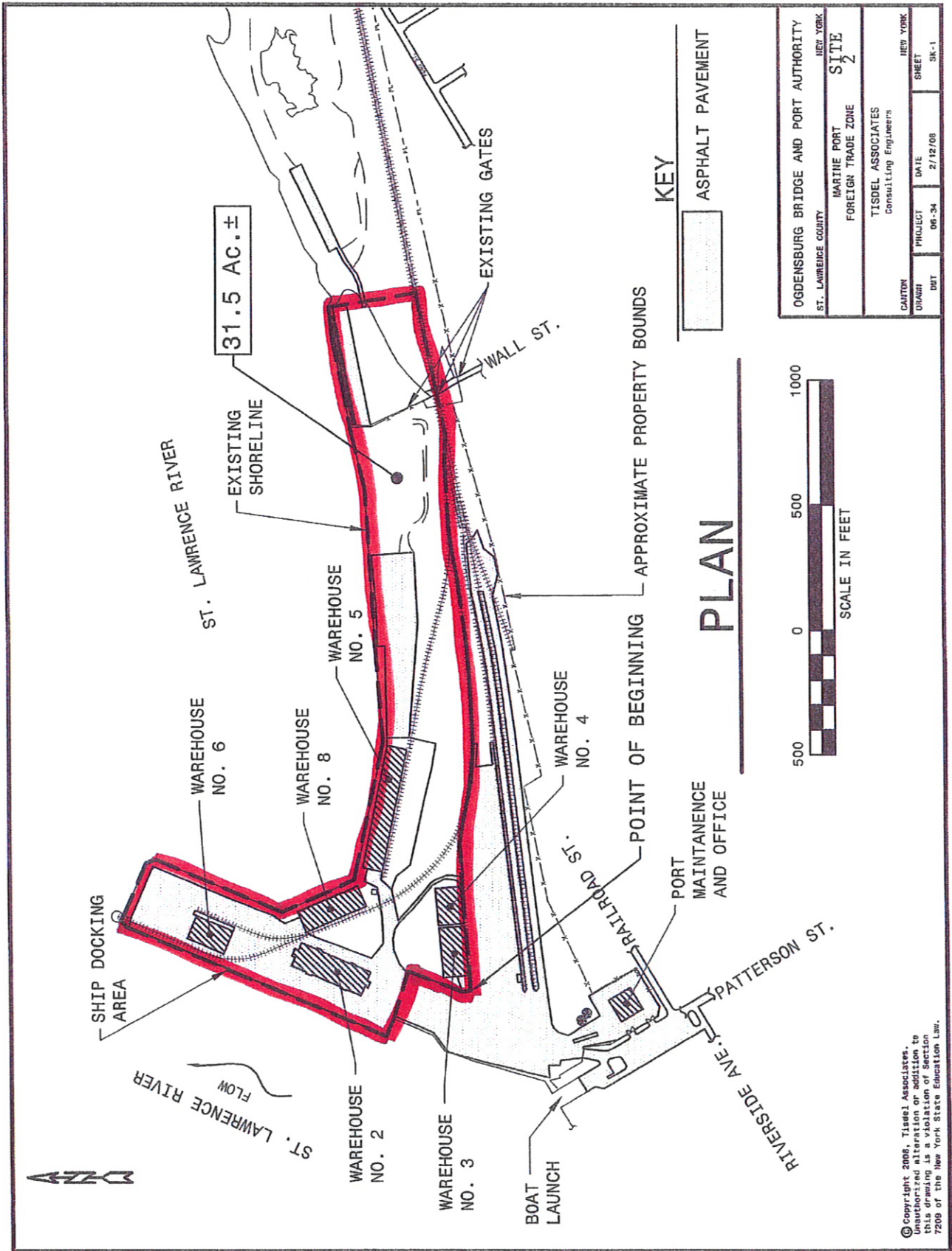

PLAN

KEY



ASPHALT PAVEMENT

OGDENSBURG BRIDGE AND PORT AUTHORITY		NEW YORK	
ST. LAWRENCE COUNTY		MARINE PORT	
		FOREIGN TRADE ZONE	
		SITE 2	
TISDEL ASSOCIATES Consulting Engineers			
CANTON	PROJECT	DATE	SHEET
004001	06-34	2/12/08	3K-1

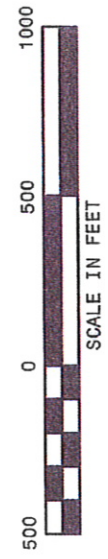

© Copyright 2008, Tisdell Associates.
Unauthorized alteration or addition to
this drawing is a violation of Section
7209 of the New York State Education Law.