

SUBDIVIDED LAND IN FOR SEC. 29, T. 23 S., R. 21 E., M. 4 S. R. 16

494-06

The State of California

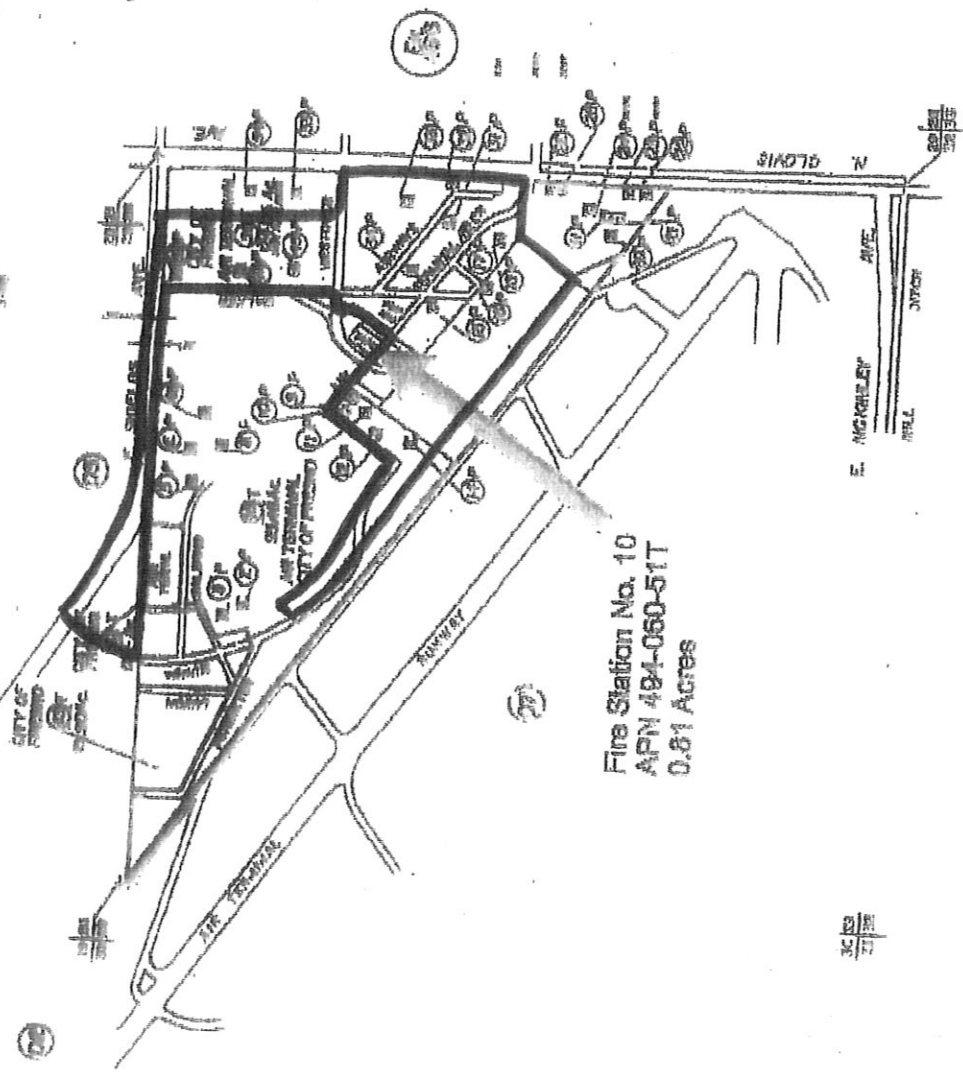

Fire Station No. 10
APN 494-060-51T
0.61 Acres

San Joaquin County - Plat Bk. 2, P. 5

Assessor's Map Bk. 494 - Pt. 03
County of Fresno, Calif

NOTE - Assessor's Block Numbers Shown in Outline
Assessor's Parcel Numbers Shown in Grey.

PL - 0139