

I:\2019\19-180\19-180\_Henry-Bath\_Baltimore-Business-Park\_7700-Rolling-Mill-Road\_Baltimore-MD\_21224\_Baltimore-County.dwg, 11x17, 10/4/2019 4:31:15 P

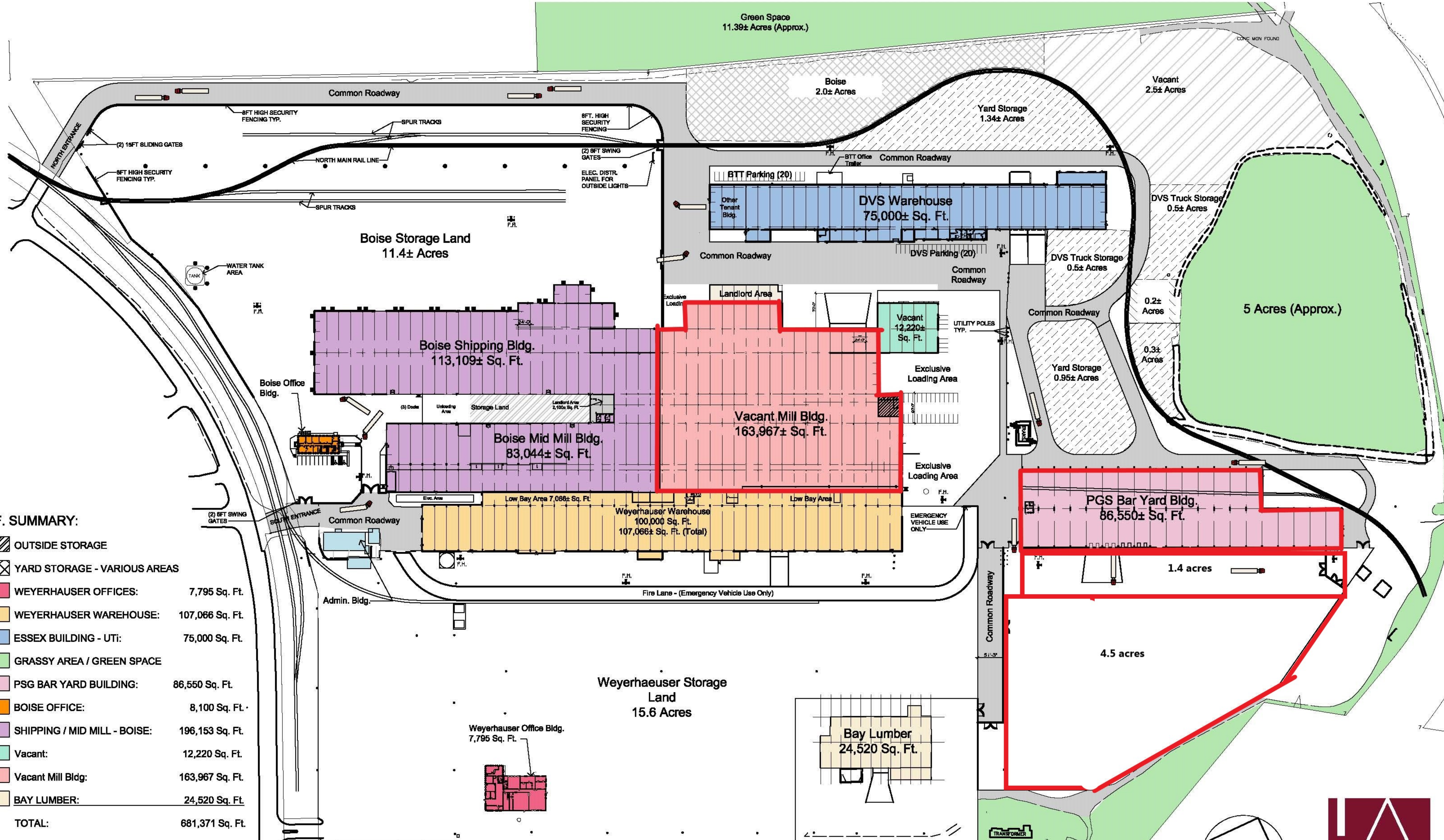

**S.F. SUMMARY:**

	OUTSIDE STORAGE	
	YARD STORAGE - VARIOUS AREAS	
	WEYERHAUSER OFFICES:	7,795 Sq. Ft.
	WEYERHAUSER WAREHOUSE:	107,066 Sq. Ft.
	ESSEX BUILDING - UTI:	75,000 Sq. Ft.
	GRASSY AREA / GREEN SPACE	
	PSG BAR YARD BUILDING:	86,550 Sq. Ft.
	BOISE OFFICE:	8,100 Sq. Ft.
	SHIPPING / MID MILL - BOISE:	196,153 Sq. Ft.
	Vacant:	12,220 Sq. Ft.
	Vacant Mill Bldg:	163,967 Sq. Ft.
	BAY LUMBER:	24,520 Sq. Ft.
<b>TOTAL:</b>		<b>681,371 Sq. Ft.</b>

**MASTER PLAN**

PROJECT NAME:  
**MASTER PLAN**

BALTIMORE BUSINESS PARK  
7700 ROLLING MILL ROAD  
BALTIMORE COUNTY, MARYLAND

PROPERTY:  
IRG REALTY SERVICES

THE CONCEPTS, IDEAS, DESIGN AND IMAGES ARE INTENDED ONLY FOR THE PROJECT SPECIFIED ON THIS SHEET AND ARE THE SOLE PROPERTY OF HOFMANN ASSOCIATES, INC. ANY REUSE OR MODIFICATION OF THESE IMAGES WITHOUT WRITTEN PERMISSION BY HOFMANN ASSOCIATES, INC.

**1 MASTER PLAN - AS OF 10/03/19**

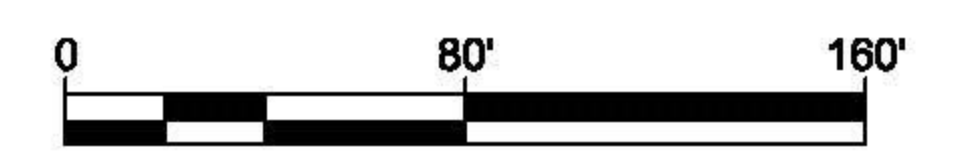

Graphic Scale

