

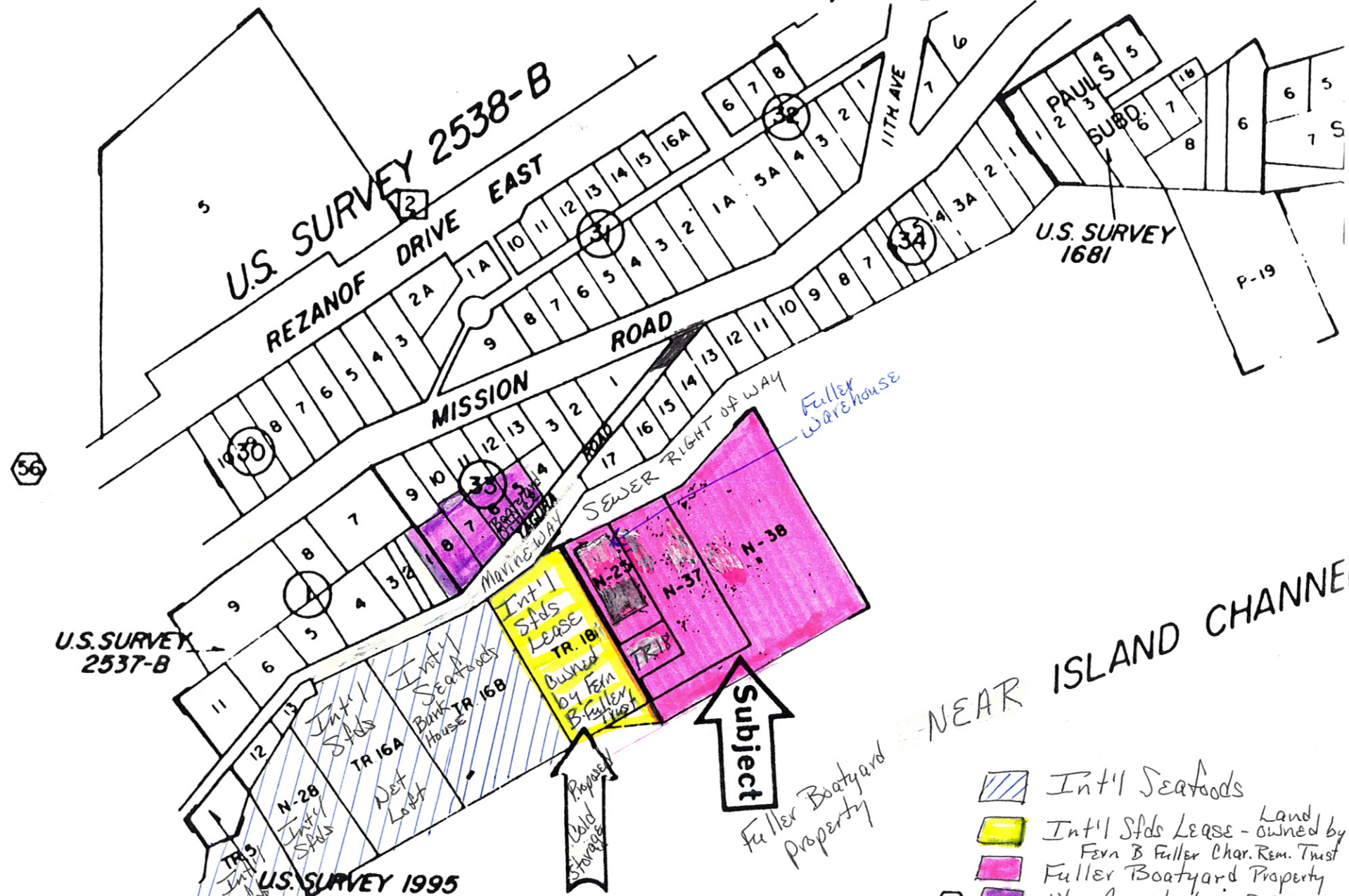



N1/2 SE1/2, SEC. 32 T29S/R21W, SM. 53



U.S. SURVEY 2537-B

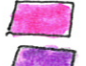

U.S. SURVEY 1995

-  Int'l Seafoods
-  Int'l Sfds Lease - Land owned by Fern B Fuller Char. Rem. Trust
-  Fuller Boatyard Property
-  vito + Anne Kalcic DBA Fuller Boatyard Inc Office

Date Compiled: JULY, 1989

Revisions		Parcel Number Ref.	Date
Parcel Number	Ref		
		1	Kodiak Township
		33	East Addition

LEGEND

-  Adjoining page numbers
-  Improvements

B