

BWB \ K:962020 \ FTZ.DWG \ 1-29-98 \ 1"=600'

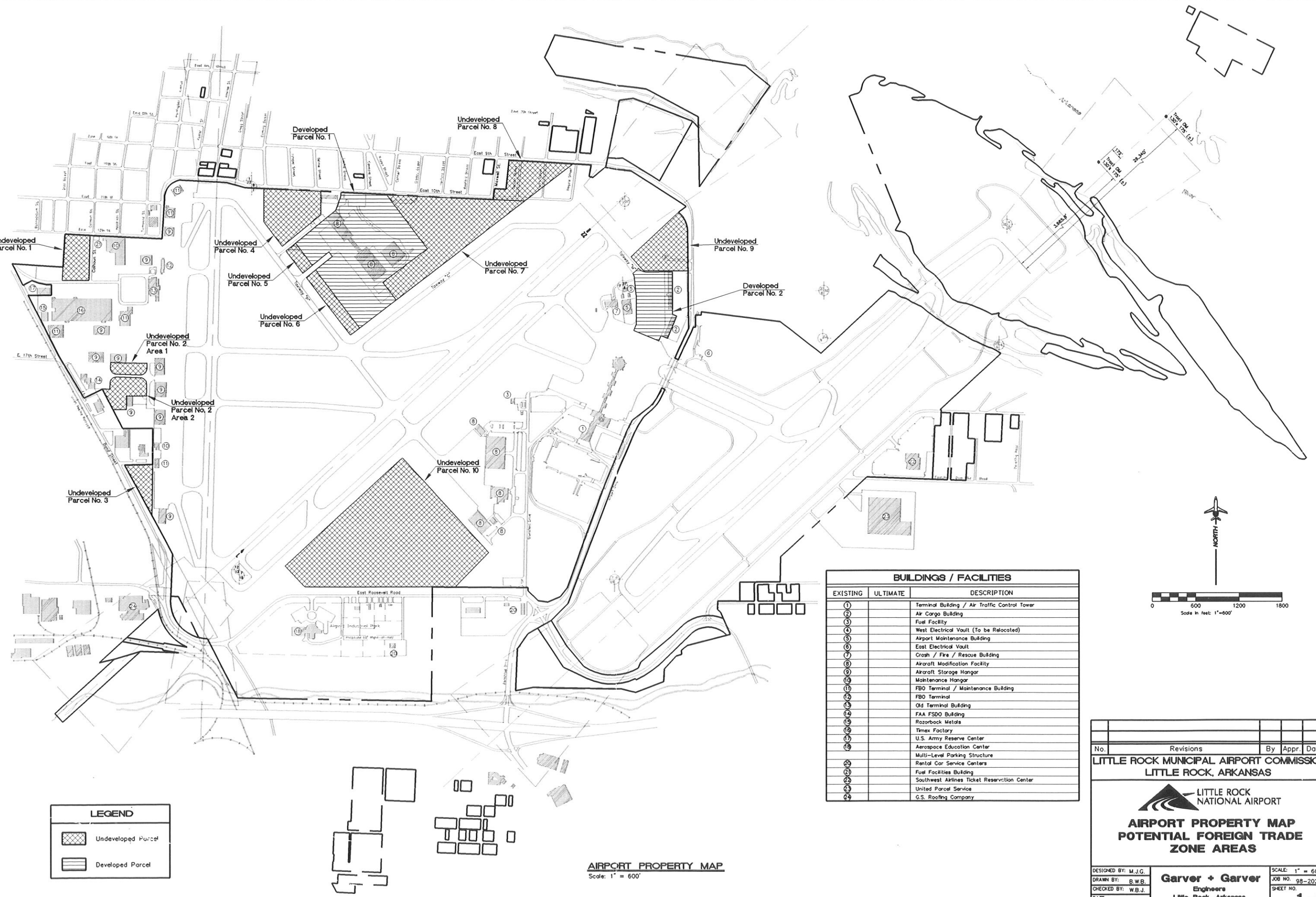

LEGEND	
	Undeveloped Parcel
	Developed Parcel

BUILDINGS / FACILITIES		
EXISTING	ULTIMATE	DESCRIPTION
①		Terminal Building / Air Traffic Control Tower
②		Air Cargo Building
③		Fuel Facility
④		West Electrical Vault (To be Relocated)
⑤		Airport Maintenance Building
⑥		East Electrical Vault
⑦		Crash / Fire / Rescue Building
⑧		Aircraft Modification Facility
⑨		Aircraft Storage Hangar
⑩		Maintenance Hangar
⑪		FBO Terminal / Maintenance Building
⑫		FBO Terminal
⑬		Old Terminal Building
⑭		FAA FSDO Building
⑮		Razorback Metals
⑯		Timex Factory
⑰		U.S. Army Reserve Center
⑱		Aerospace Education Center
⑲		Multi-Level Parking Structure
⑳		Rental Car Service Centers
㉑		Fuel Facilities Building
㉒		Southwest Airlines Ticket Reservation Center
㉓		United Parcel Service
㉔		G.S. Roofing Company

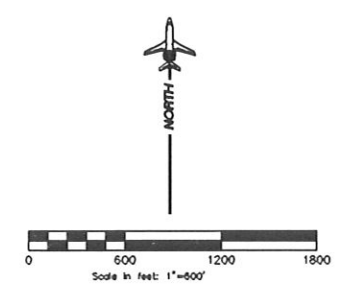

AIRPORT PROPERTY MAP
Scale: 1" = 600'

No.	Revisions	By	Appr.	Date
LITTLE ROCK MUNICIPAL AIRPORT COMMISSION LITTLE ROCK, ARKANSAS				
 LITTLE ROCK NATIONAL AIRPORT AIRPORT PROPERTY MAP POTENTIAL FOREIGN TRADE ZONE AREAS				
DESIGNED BY: M.J.G.	SCALE: 1" = 600'			
DRAWN BY: B.W.B.	JOB NO. 98-2020			
CHECKED BY: W.B.J.	SHEET NO.			
DATE: January, 1998	Garver + Garver Engineers Little Rock, Arkansas			1 of 1