

ALL WEATHER WIND ROSE
 NEW RIVER VALLEY DUBLIN, VIRGINIA
 WIND ROSE DATA OBTAINED FROM PULASKI, VA
 PERIOD COVERED - NOV. 1943 THRU DEC. 1946
 RUNWAY COVERAGE - 93.7%
 Δ +18.3% CALMS 0-3 MPH

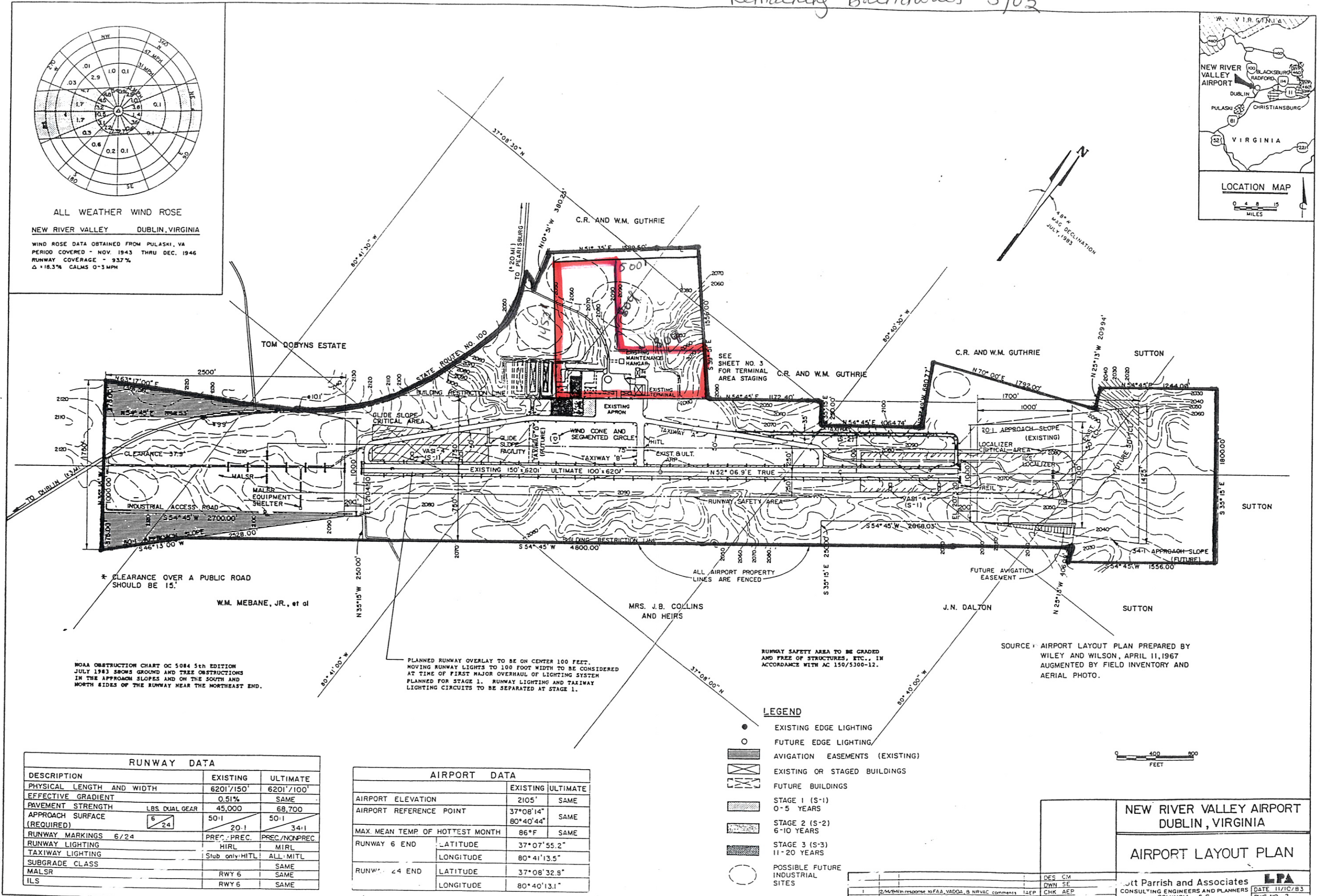
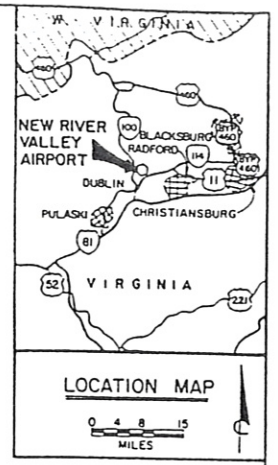

* CLEARANCE OVER A PUBLIC ROAD SHOULD BE 15'

NOAA OBSTRUCTION CHART OC 5084 5th EDITION JULY 1983 SHOWS GROUND AND TREE OBSTRUCTIONS IN THE APPROACH SLOPES AND ON THE SOUTH AND NORTH SIDES OF THE RUNWAY NEAR THE NORTHEAST END.

PLANNED RUNWAY OVERLAY TO BE ON CENTER 100 FEET. MOVING RUNWAY LIGHTS TO 100 FOOT WIDTH TO BE CONSIDERED AT TIME OF FIRST MAJOR OVERHAUL OF LIGHTING SYSTEM PLANNED FOR STAGE 1. RUNWAY LIGHTING AND TAXIWAY LIGHTING CIRCUITS TO BE SEPARATED AT STAGE 1.

RUNWAY SAFETY AREA TO BE GRADED AND FREE OF STRUCTURES, ETC., IN ACCORDANCE WITH AC 150/5300-12.

SOURCE: AIRPORT LAYOUT PLAN PREPARED BY WILEY AND WILSON, APRIL 11, 1967 AUGMENTED BY FIELD INVENTORY AND AERIAL PHOTO.

RUNWAY DATA		
DESCRIPTION	EXISTING	ULTIMATE
PHYSICAL LENGTH AND WIDTH	6201' / 150'	6201' / 100'
EFFECTIVE GRADIENT	0.51%	SAME
PAVEMENT STRENGTH	45,000	68,700
APPROACH SURFACE (REQUIRED)	50:1	50:1
	20:1	34:1
RUNWAY MARKINGS	6/24	PREC./PREC.
RUNWAY LIGHTING	HIRL	MIRL
TAXIWAY LIGHTING	Stub only: HITL	ALL: MITL
SUBGRADE CLASS	SAME	SAME
MALSR	RWY 6	SAME
ILS	RWY 6	SAME

AIRPORT DATA		
	EXISTING	ULTIMATE
AIRPORT ELEVATION	2105'	SAME
AIRPORT REFERENCE POINT	37°08'14"	SAME
	80°40'44"	
MAX MEAN TEMP OF HOTTEST MONTH	86°F	SAME
RUNWAY 6 END	LATITUDE	37°07'55.2"
	LONGITUDE	80°41'13.5"
RUNWAY 24 END	LATITUDE	37°08'32.8"
	LONGITUDE	80°40'13.1"

- LEGEND**
- EXISTING EDGE LIGHTING
 - FUTURE EDGE LIGHTING
 - ▨ AVIGATION EASEMENTS (EXISTING)
 - ▩ EXISTING OR STAGED BUILDINGS
 - ▧ FUTURE BUILDINGS
 - ▨ STAGE 1 (S-1) 0-5 YEARS
 - ▩ STAGE 2 (S-2) 6-10 YEARS
 - ▧ STAGE 3 (S-3) 11-20 YEARS
 - POSSIBLE FUTURE INDUSTRIAL SITES

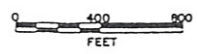

NEW RIVER VALLEY AIRPORT
 DUBLIN, VIRGINIA

AIRPORT LAYOUT PLAN

W. Parrish and Associates
 CONSULTING ENGINEERS AND PLANNERS
 COLUMBIA, S.C.

DES: CM
 DWN: SE
 CHK: AEP
 PROJ: 11-101

DATE: 11/10/83
 DWG. NO. 2

REVISION	DATE	DESCRIPTION	BY
1	12/18/83	RESPONSE TO FAA, WADOB, B, NRVAC COMMENTS	IAEP